

Cayuga Community College Theatre

- Technical Specifications

Fly Line Schedule

- Stage Floor to bottom of steel: 23'-3"
- Maximum Fly height: 22'-0"
- All Battens are ~40' 1 1/2" schedule 40 black pipe.
- Battens can be flown down to ~5'-0" from deck.
- Drops **cannot** be flown out of site.
- Main curtain is a dead hung Red Velour traveler (2- 18' x 20' panels) approximately 1' US from plaster line. All dimensions are from the curtain line. Operated from SR.
- Arbor capacity ~ 500#
- Fly Rail is a wire guide system operated from SL.
- Legs, Borders and Backdrop are Black Duvetyn.
- Mid-Stage Traveler is Black Commando Cloth. (Operated from SR, also serves as 2nd leg.)
- Also available are a Black Scrim, White Scrim and Natural Muslin Drops. All 18' X40'.
- Note: Line 18 can be tied off and breasted US to ~9" from US wall.
- Note: Line 17 can be tied off and breasted US to ~24" from US wall.

Line	Distance from Curtain line	Assignment	Curtain Size
1	6"	1 st Border	4'H x 37'W (Hard framed)
2	1'-3"		
3	2'-0"	1 st Electric	
4	3'-2"	1 st Legs	7'-6"W x 18'H
5	4'-3"		
6	5'-0"	2 nd Border	4'-9"H x 38'W
7	6'-3"		
8	6'-9"	Mid-Stage Traveler	(2) 20'W x 18'H
9	8'-6"	2 nd Electric	
(Fluorescent Work Lights on underside of steel)			
10	9'-9"		
11	10'-6"	3 rd Border	4'H x 38'W
12	11'-3"		
13	12'-3"	3 rd Legs	8'W x 18'H
14	13'-6"	3 rd Electric	
15	14'-3"	4 th Border	3'H x 38'W
16	15'-6"	Strip Lights	
17	16'-6"		
18	17'-3"	Back Drop	(2) 20'W x 18'H

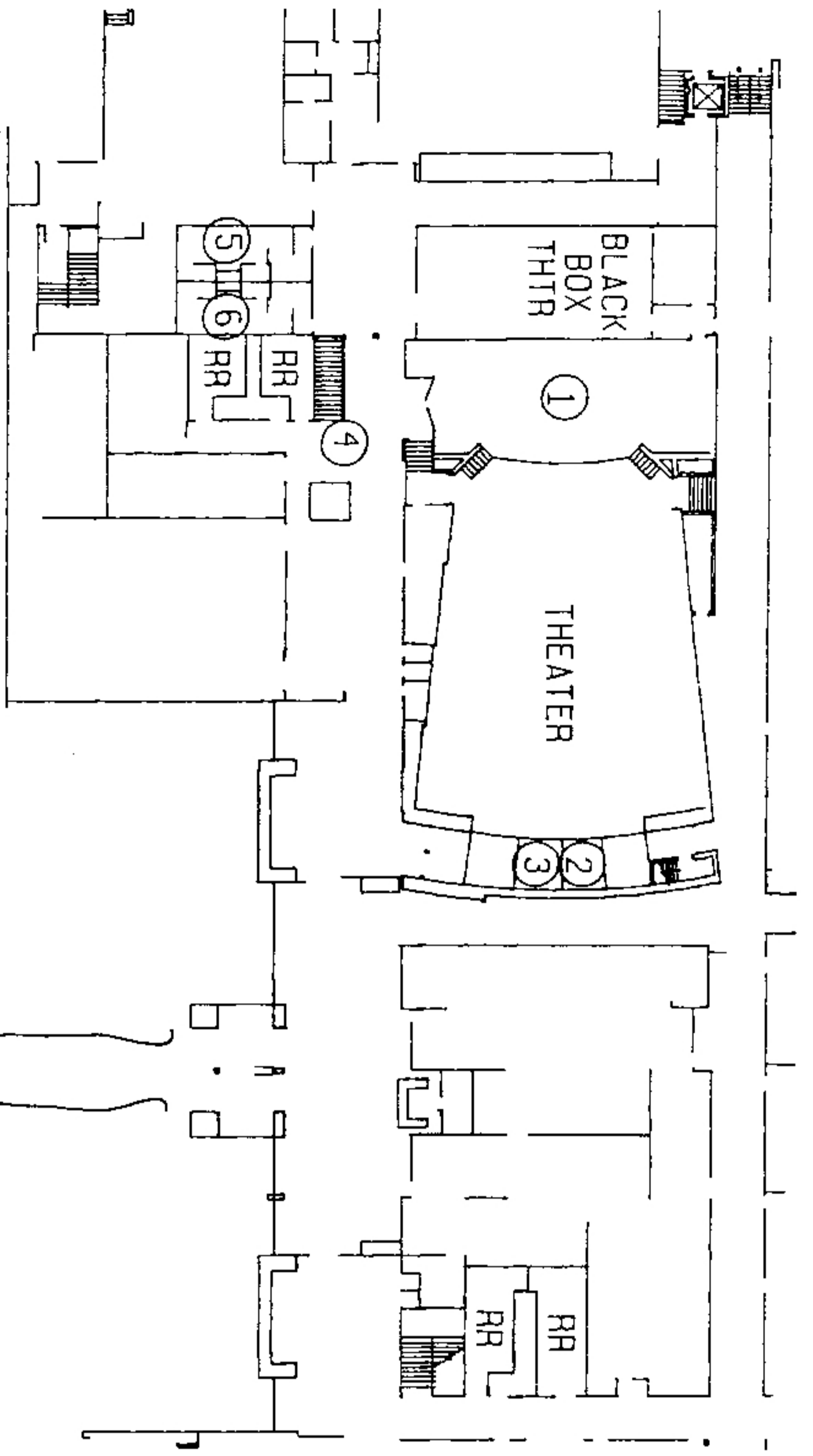

Cayuga Community College, Auburn, NY

KEY:

- 1. STAGE
- 2. Control Booth
- 3. Spot Booth
- 4. Stairway to Cafeteria
- 5. Dressing Room - M207
- 6. Dressing Room - M208

☒ = Elevator

RR = Restrooms

Dimmer Locations

03/21/2007 King Kluge

USR Deck 163-168 1K Each	<i>UpStage Wall</i>		USL Deck 157-162 1K Each
	120 2K Pairs	4th Electric	109 2K Pairs
	108 2K Pairs	3rd Electric	85 2K Pairs
Mid SR Deck 151-156 1K Each	84 2K Pairs	2nd Electric	61 2K Pairs
	60 2K Pairs	1st Electric	37 2K Pairs
DSR Deck 145-150 1K Each			DSL Deck 139-144 1K Each
		<i>ProscLine</i>	
		Apron Pipe 133-138 1K Each	

Front of House

HL Tower 127-132 1K Each	36 2K Pairs	Cove	1 2K Pairs	HR Tower 121-126 1K Each
---------------------------------------	----------------	------	---------------	---------------------------------------

Instrument Wattages:

- | | |
|------------------|---|
| Ellipsoidal 575W | Two per Dimmer |
| Fresnel 750W | One per Dimmer |
| StripChan 375W | Four per 1/2 Paired Dimmer (leave adjacent open). |